

PGM-FI System

Lock-up Control Solenoid Valve (A/T)

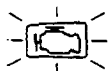

19

The Malfunction Indicator Lamp (MIL) indicates Diagnostic Trouble Code (DTC) 19: A problem in the Lock-up Control Solenoid Valve A and/or B circuit.

- The MIL has been reported on.
- With the SCS short connector connected (see page 11-14), code 19 is indicated.

Do the ECM Reset Procedure (see page 11-15).

Test drive necessary.
Drive the car for several miles so that the transmission upshifts and downshifts several times.

Is the MIL on and does it indicate code 19?

NO

Intermittent failure, system is OK at this time.
Check for poor connections or loose wires between the lock-up control solenoid valve A/B and the ECM.

YES

Turn the ignition switch OFF.

Connect the test harness to the main harness only, not to the ECM (see page 11-17).

Disconnect the 2P connector from the lock-up control solenoid valve.

Check for continuity between A19 or A17* and body ground.

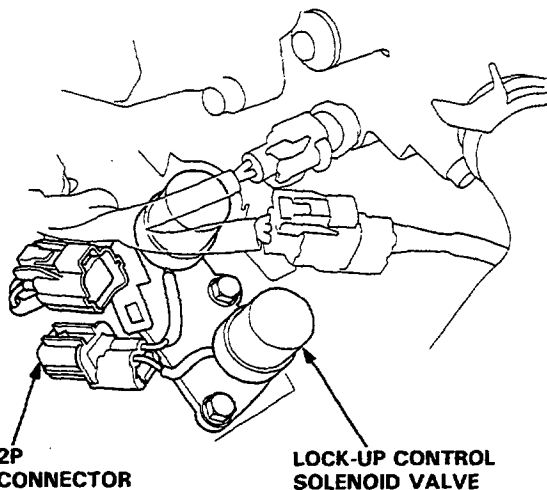

2P CONNECTOR

LOCK-UP CONTROL SOLENOID VALVE

*: Lock-up Control Solenoid Valve B

Does continuity exist?

YES

Repair short in YEL or GRN/BLK* wire between ECM (A19 or A17*) and the 2P connector.

NO

(To page 11-57)

